

## GWAL-LP Low Profile Threaded Insert

Aluminium · Low profile · Round · Open end  
M4 - M8

### Features

- Designed to provide load bearing threads in thin sheet materials
- Low profile head allows near flush fit to application

### Material

- Aluminium 5052

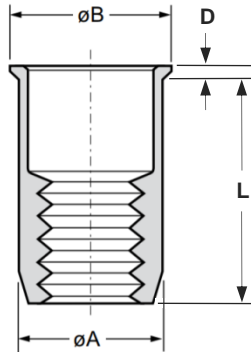

Before Placement

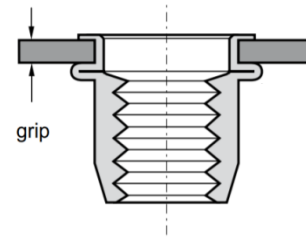

After Placement

Part No.	Thread Size	Grip Range		Hole Size	øA	øB	D	L
		min.	max.	+0.1	-0.02/-0.15	-0.15 / +0.3	-0.05 / +0.3	±0.35
GWAL-LPM4-0530	M4	0.5	3.0	6.0	6.0	6.5	0.5	10.75
GWAL-LPM5-0530	M5	0.5	3.0	7.0	7.0	7.5	0.5	12.0
GWAL-LPM6-0530	M6	0.5	3.0	9.0	9.0	9.5	0.5	14.5
GWAL-LPM8-0530	M8	0.5	3.0	11.0	11.0	11.5	0.5	16.0

Thread Size	Max. torque	Pull-out	Torque-to-turn	Shear strength
	Nm max.	Kn	Nm	kN
M4	~4.9	> ~4.5	~1.4	~1.1
M5	~4.9	> ~5.2	~1.5	~1.6
M6	~16.0	> ~10.5	~3.2	~2.4
M8	~33.0	> ~15.0	~5.3	~2.9



### Can't find what you are looking for?

We can provide unique and customized solutions.  
Contact your nearest [Gripwell](#) team for assistance!